

JBC

www.jbctools.com

Product
webpage



INSTRUCTION MANUAL



BCB

Charging-Base for B·IRON

This manual corresponds to the following reference:

BCB-5A

Packing List

The following items are included:



Charging-Base for B-IRON 1 unit



B-IRON Display Holder 5" to 7" 1 unit

Ref. 0030723

Includes fixing knob.



Brass Wool
for B-IRON Charging-Base 1 unit

Ref. CL0300

Already assembled in the charging base.



Power Cord * 1 unit

Ref. 0027380 120V - N. America / Taiwan

0027381 230V - India

0027382 230V - Europe

0027378 230V - United Kingdom

** One power cord included depending on customer requirements.*



Manual 1 unit

Ref. 0033736

 Please read this manual and its safety guidelines thoroughly before using the product.

Features and Connections

BCB Charging-Base works with the B-IRON tool and charging holder range.

BCB - Front view



BCB - Rear view



ESD Safe Connection

Note: All B-IRON components comply with CE standards, but the tool by itself is not grounded. Therefore, to comply with ESD regulations, the user of the B-IRON tool must be ESD-compliantly grounded.

JBC offers ESD tablemats, earthing cables, plugs and wristbands. More info on www.jbctools.com.

Workplace Example

Single-Tool Setup



** It is possible to use either JBC's PDS Portable Display or the user's own smartphone or tablet as a display. More information on how to work with your own devices on section "B-IRON App Installation and Updating".*



*** B-IRON tools and charging holders can be assembled, used and combined according to the user's needs. Check the compatibility table for more details.*

Workplace Example

Dual-Tool Setup



Compatibility

Charging holder references	Tool references			
	B-100	B-500	B-NANO	B-TWEEZERS
For handles: H2464 (left) / H2465 (right) 	●	●	●	
For tweezers: H2466 (left) / H2467 (right) 				●

Station Setup

Display Holder Assembling

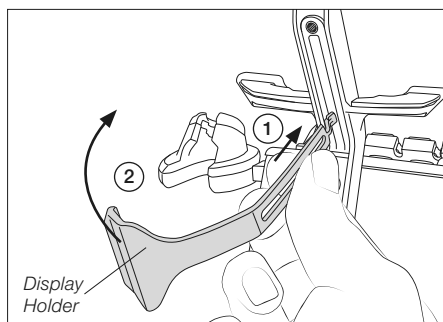

Insert the thin end of the display holder into the upper area of the rear rail of the charging base (1). Then carefully rotate the display holder 90 degrees (2) until it stands vertical.

Display Holder Setting

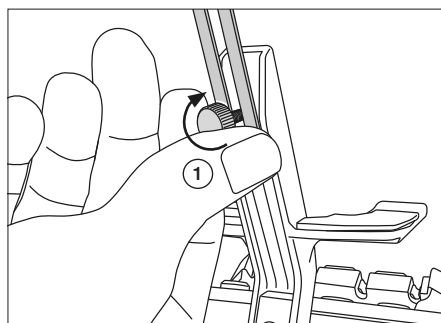

Insert the fixing knob (1) and tighten it just enough so that it stays in place but the display holder can be moved.

Base and Display Connection

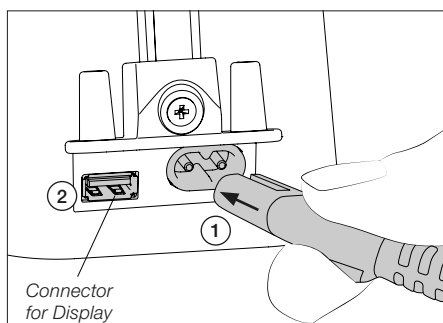

Connect the charging base to the mains (1).

The display can be connected to the USB port (2) with the provided USB cable to keep it charging while working.

Display Placing

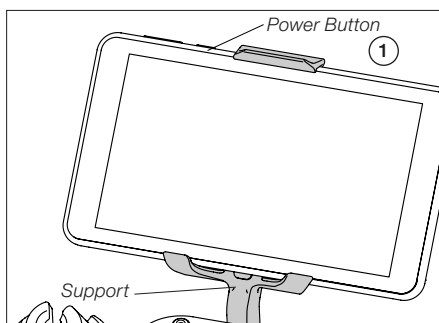

Place the display on the support with its buttons facing upwards (1). Adjust the height of the display holder by tightening the fixing knob.

Turn on the display by holding down the power button for a while (1) and then open the B-IRON app*:



*** Note:** The app can also be downloaded to your own devices. To know how, see section “Installing and Updating the B-IRON App”.

Charging Holder Assembly

Charging holders can be replaced by loosening the screws at the bottom of the charging-base.

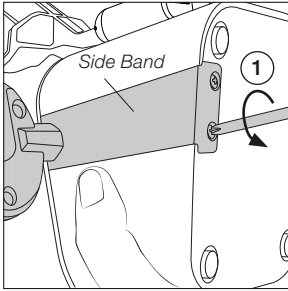

Loosen the screws (1) at the bottom.

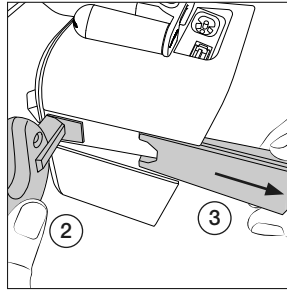

Hold the charging holder with one hand (2) and with the other pull the side band downward (3).

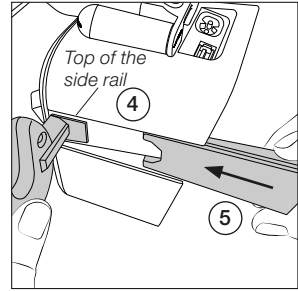

To install a new charging holder, place it at the top of the side rail (4) and slide back the side band (5) until the holder is secured in place. Finally tighten the screws at the base.

JBC Software

No installation or initial download are required for newly purchased JBC products. Both JBC display and tools come with its current software/firmware installed and updated, and are ready to use.

Note:

App: If a third-party display (tablet or smartphone) is used, the B-IRON app must be downloaded from JBC's web page and installed on the device.

Firmware: The tool's firmware is not automatically updated and the updates must be carried out manually by the user. To do so, follow the instructions on the next page.

App Versions

Make sure that the required app version is installed on the display (tablet or smartphone):

- Handles require app versions **1.6** or higher.
- Tweezers require app versions **1.7** or higher.

App Installation

On **JBC's portable display** (*Android*), the B-IRON app is already installed.

On the **user's smartphone or tablet** (*Android / iOS*), go to the App Store/Play Store and search for "JBC B-IRON" on the search bar. **Note:** Internet connection is required to download the app.

Alternatively, scan these QR codes to access the B-IRON app page directly:



App Update

Display with Internet connection (*Android / iOS*)
Update the app via Google Play (*Android*) or the App Store (*iOS*).

Display without Internet connection (*Android*)
Download JBC's installer program to another device with an Internet connection from JBC's website: <https://www.jbc tools.com/jbcsoftware.html>



Then copy the downloaded program to the internal storage of the display used with B-IRON. Access the internal storage of the display and run the downloaded program. Once the program is completed, the app will be updated to the latest version.

Note: For JBC displays, swipe down to open the internal storage folder.

Accessories

B-IRON Display Holder 10" to 13"
Ref. 0031246

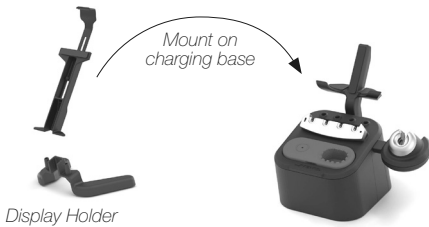

In addition to the display holder supplied with the B-IRON station, JBC offers a holder for tablet sizes between 10" and 13".

Accessories *(continuation)*

Tool Expansion Kits for B-IRON Stations

B·NANO K*

Nano Handle Expansion Kit

This kit allows extending B-IRON stations with B·NANO Handle.

Works with C115 Cartridges.



B·TWEEZERS K*

Nano Tweezer Expansion Kit

This kit allows upgrading B-IRON stations to a rework station by adding B·TWEEZERS.

Works with C115 Cartridges.



B·100 K*

Light Handle Expansion Kit

This kit allows extending B-IRON stations with B·100 Light Handle.

Works with C210 Cartridges.



B·500 K*

Handle Expansion Kit

This kit allows extending B-IRON stations by adding B·500 Handle.

Works with C210 Cartridges.

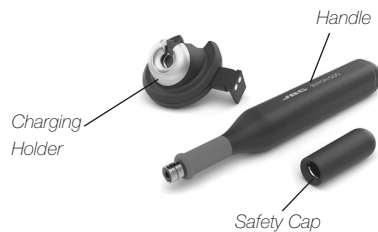

** Cartridges not included.*

To charge the tools, a B-IRON charging base or station is needed.

Required app version: For handles 1.6 or higher and for tweezers 1.7 or higher.

Maintenance

Before carrying out maintenance, always extract the cartridge from the tool and disconnect the charging base from the mains. Allow the equipment to cool down.

- Use a damp cloth to clean the casing and the tool. Alcohol can only be used to clean the metal parts.
- Periodically check that the metal parts of the tool and charging holder are clean so that the charging works properly.
- Keep the tip surface clean and tinned prior to storage in order to avoid tip oxidation. Rusty and dirty surfaces reduce heat transfer to the solder joint.
- Do not use liquids such as alcohol, thinner or benzene to clean the portable display.
- Repairs should only be performed by a JBC authorized technical service.



Safety - Battery



It is imperative to follow safety guidelines to prevent electric shock, injury, fire or explosion.

- **Caution:** This product contains lithium-ion batteries. Mishandling or improper use may result in fire, explosion, or personal injury.
- Always use the provided charger. Do not use damaged chargers or batteries.
- Never attempt to disassemble or modify the batteries or the product. Doing so may lead to electric shock, fire, or damage to the product.
- In the event of damage, leakage, or overheating of the batteries, discontinue use immediately and contact customer support or JBC technical service facility.
- Dispose of devices with batteries inside, responsibly according to regulations. They must be disposed of in accordance with local regulations so that they can be recycled.
- Do not throw devices with batteries into household waste and do not dispose of them in fire or water.

Safety



It is imperative to follow safety guidelines to prevent electric shock, injury, fire or explosion.

- Do not use the units for any purpose other than soldering or rework. Incorrect use may cause a fire.
- The power cord must be plugged into approved bases. When unplugging it, hold the plug, not the wire.
- Do not attempt to dismantle or open the housing of the tool as it may cause damage.
- Do not work on electrically live parts.
- The tool should be placed in the charging holder when not in use in order to charge the batteries.
- The soldering tip, the metal part of the tool and the charging holder may still be hot even when the station is turned off.
- Do not leave the tool unattended when it is on.
- Avoid flux coming into contact with skin or eyes to prevent irritation.
- Be careful with the fumes produced when soldering.
- Keep your workplace clean and tidy. Wear appropriate protection glasses and gloves when working to avoid personal harm.
- Utmost care must be taken with liquid tin waste, which can cause burns.
- This appliance can be used by children over the age of eight and also persons with reduced physical, sensory or mental capabilities or lack of experience provided that they have been given adequate supervision or instruction concerning the use of the appliance and understand the hazards involved. Children must not play with the appliance.
- Maintenance must not be carried out by children unless supervised.
- Do not expose the portable display to high temperatures, humidity or dust. Avoid direct sunlight.
- Do not drop the portable display or the tool, as it may cause damage or malfunction.
- Do not disconnect your device when it is in file transfer mode.
- Do not use the portable display in places where wireless communications are restricted.

Specifications

BCB

Charging-Base for B-IRON

Ref. **BCB-5A**

- Input:	100 V - 240 V 50/60 Hz
- Nominal Power:	40 W
- Tool Output:	12 V / 1000 mA
- USB Output:	5 V / 1000 mA
- Total Net Weight:	1.64 kg / 3.61 lb
- Total Package Dimensions/Weight: (L x W x H)	223 x 223 x 160 mm / 1.95 kg 8.78 x 8.78 x 6.30 in / 4.3 lb

Complies with CE standards.

ESD Safe (to comply with ESD requirements, see page 3).

JBC

Warranty

JBC's 2 year warranty covers this equipment against all manufacturing defects, including the replacement of defective parts and labor.

Warranty does not cover product wear or misuse.

In order for the warranty to be valid, equipment must be returned, postage paid, to the dealer where it was purchased.

Get 1 extra year JBC warranty by registering here:

<https://www.jbctools.com/productregistration/>

within 30 days of purchase.

If you register, you will receive e-mail notifications about new software updates for your registered product.



This product should not be thrown in the garbage.

In accordance with the European directive 2012/19/EU, electronic equipment at the end of its life must be collected and returned to an authorized recycling facility.

**CE EAC UK
CA**

www.jbctools.com