

JBC

www.jbctools.com

INSTRUCTION MANUAL



SMR

Multiplexer for Robot

This manual corresponds to the following references:

SMR-A

Packing List

The following items are included:



Multiplexer for Robot 1 unit



Cable DB9M-DB9F (2m) 1 unit
Ref. 0028514



Cabel M8F-M8M 5V (3m) 2 unit
Ref. 0021333



AC Adapter 1 unit
Ref. 0028084



Manual 1 unit
Ref. 0023789

*Download the **Robot Control Software**, available at
www.jbctools.com/jbcsoftware.html

Features

SMR simplifies the connection between the PC or PLC and the JBC stations by multiplexing one serial communication port towards two JBC Devices.

- **UCR** - Control Unit for Automation (serial communication RS-232*)
- **SFR** - Solder Feeder for Robot (serial communication RS-232*)

*See corresponding "Communication Protocol" at www.jbctools.com/jbcsoftware.html.

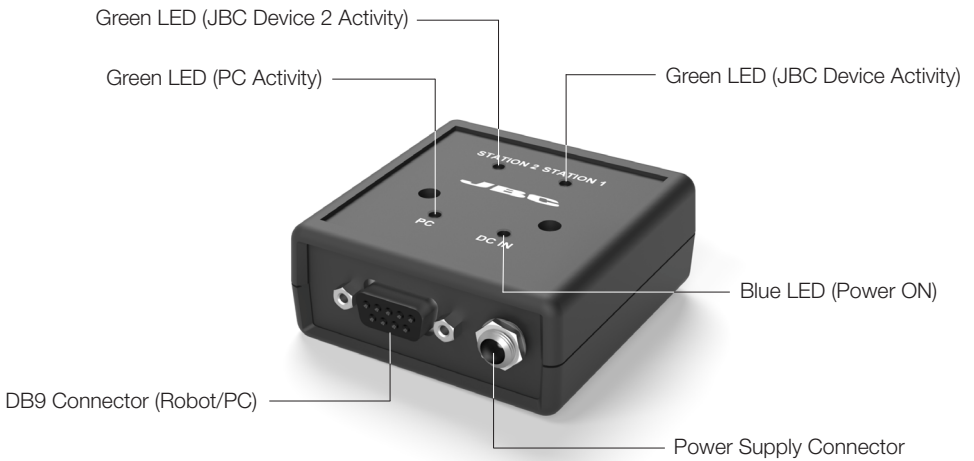

Connection

Connection module for automation process

Ref. SMR-A

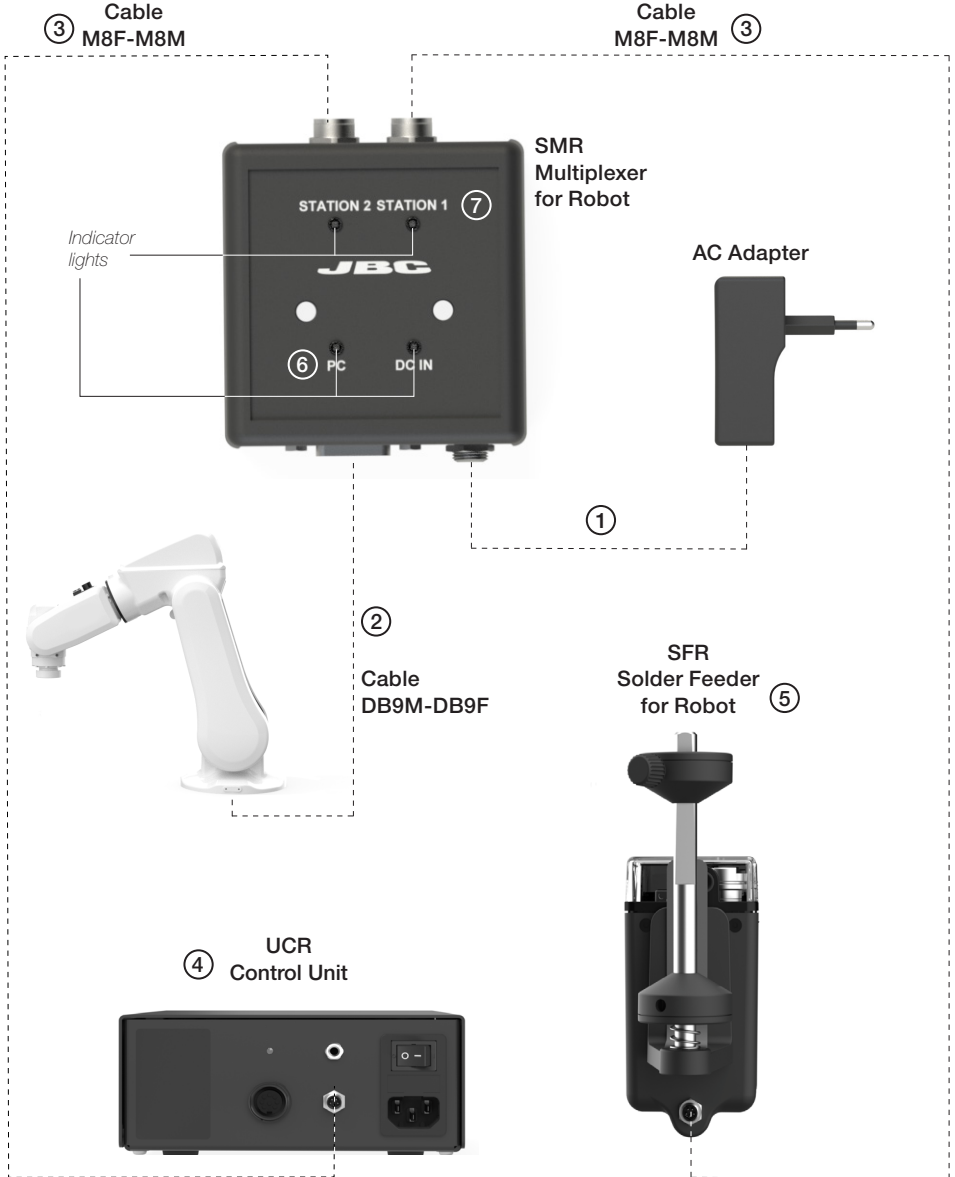

Installation

Connect the SMR with the supplied AC adapter (1). The DC IN indicator must become lighted

Connect the PC/PLC serial port DB9 male connector to the SMR by using the DB9 cable (2).

Connect two JBC Devices to the SMR by using the M8F-M8M 5V 3M cables (3). Typical devices are the UCR Control Unit (4) and de SFR Solder Feeder for Robot (5).

Ensure that both device protocol settings are configured as "WITH ADDRESS" and the address of each device is different. Default address values is 01 for the UCR and 10 for the SFR.

LED Indicators

The indicator lights STATION 1, STATION 2, and PC are very useful for debugging communications:

PC Indicator Light

PC indicator (6) blinks every time the PC sends bytes to the stations. If this led doesn't blink, the port number assigned to the communication software is incorrect.

Station Indicator Light

STATION1 and STATION2 lights (7) blink when the JBC devices answers a frame to the PC. If these lights don't blink, check if the address settings are properly defined.

If the device address is unknown, JBC recommends to download the **Robot Control Software*** and use the "Discovery Connected Devise" funktion.

**available at www.jbctools.com/jbcsoftware.html*

Maintenance

- Before carrying out maintenance, always allow the equipment to cool down.
- Periodically check all cables and connections.
- Replace any defective or damaged part. Use original JBC spare parts only.
- Repairs should only be performed by JBC and authorized technical service.

Safety



It is imperative to follow safety guidelines to prevent electric shock, injury, fire or explosion.

- Do not use the device for other purpose.
- The AC Adapter must be plugged into approved bases. When unplugging it, hold the plug, not the wire.
- Be sure that the power supply is disconnected before changing any spare part.
- Keep your workplace clean and tidy. Wear appropriate protection glasses and gloves when working to avoid personal injury.

Specifications

SMR

Multiplexer for Robot

Ref. **SMR-A**

- | | |
|---|--|
| - Total Net Weight: | 505 g / 1.11 lb |
| - Package Dimensions/Weight:
(L x W x H) | 246 x 184 x 42 mm / 567 g
9.69 x 7.24 x 1.65 in / 1.25 lb |

Complies with CE standards.
ESD safe.

JBC

Warranty

JBC's 2 year warranty covers this equipment against all manufacturing defects, including the replacement of defective parts and labour.

Warranty does not cover product wear or misuse.

In order for the warranty to be valid, equipment must be returned, postage paid, to the dealer where it was purchased.



This product should not be thrown in the garbage.

In accordance with the European directive 2012/19/EU, electronic equipment at the end of its life must be collected and returned to an authorized recycling facility.



www.jbctools.com